



FIRST PRESBYTERIAN CHURCH
WINTER HAVEN

Tower Chimes

Week of March 15, 2015

Issue 534

129 Years of Ministry

Dr. Steven R. Negley
Senior Pastor

Dr. C. Alan Harvey
Associate Pastor

Dr. Raymond M. Larson
Minister of Visitation

Dr. James G. Manor
Parish Associate

Amy L. McKee
Director of
Christian Education

Dana H. Parrish
Director of
Student Ministries

Cheryce D. Harris
Interim Choir Director

Lynn McCoy
Interim Organist

Ronda A. Lacy
Director of Finance &
Administration

Connie J. Shipley
Administrative Assistant

Rose Flynn
Office Assistant

Sammy D. Bryant
Director of Maintenance

Ann M. Quessenberry
Custodian

SUNDAY, MARCH 15 WILL BE THE FOURTH SUNDAY IN THE SEASON OF LENT

During the season of Lent, Dr. Negley and Dr. Harvey will be preaching through the Gospel According to John. As the weeks unfold, we will:



- ♦ focus on Jesus as the object of our faith (John 1:19-4:54)
- ♦ witness Christ's conflict with unbelievers (John, chapters 5-12)
- ♦ enjoy Jesus' fellowship with his followers (John, chapters 13-17)
- ♦ and remember His death, resurrection, and events which followed (John, chapters 18-21).

**Bring your Bible, and join us each week in worship
as we experience again the life-changing power
of Christ's presence.**



DON'T FORGET: OM, OM BOOK DISCUSSION CLUB

Our **Odd Month, Odd (3rd) Monday Book Discussion Club** will meet again on **March 16 at 3:00 p.m.**

We will have some light refreshments and will discuss Bill O'Reilly and Martin Dugard's book, *Killing Jesus*.

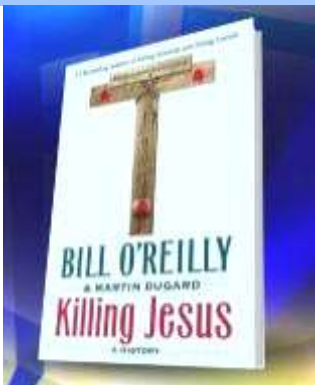

Church calendar

Sunday, March 15
4th Sunday in Lent

8:50 a.m. Worship
9:30 a.m. OJ Fellowship (MH)
9:45 a.m. Sunday School-Children & Youth
10:00 a.m. Sunday School-Adults
11:00 a.m. Worship
5:30 p.m. HSYG (GSH)

Monday, March 16

8:45 a.m. MOM
3:00 p.m. OM, OM Book Club (UR)
6:15 p.m. Worship & Music (UR)
6:30 p.m. Christian Education (GR)

Tuesday, March 17

9:00 a.m. Staff Meeting (MCR)
9:30 a.m. Joy Circle (Off-site)
12:00 p.m. Men's Lunch (MH)
12:00 p.m. Finance (UR)
6:30 p.m. Deacons (GR)

Wednesday, March 18

8:45 a.m. MOM
3:00 p.m. Christ Kids
5:15 p.m. Confirmation (GSH)
5:30 p.m. MSYG (GSH)
6:00 p.m. Director of Music Search (MCR)
6:00 p.m. Chancel Bells
7:00 p.m. Chancel Choir

Thursday, March 19

9:00 a.m. Women's Bible Study (UR)
7:00 p.m. Chapel Bells

Friday, March 20

8:45 a.m. MOM

Saturday, March 21

2:00 p.m. Soup Kitchen Prep (Kitchen)
4:00 p.m. Soup Kitchen (737)
7:00 p.m. Saturday Nite Live (MH)

Lord hear
Our prayers.



Remember in Prayer

members

Win Betrus	Doris Hill	Liz Purnell
R. Otis Bice, Jr.	Ed Houston	Howard Rambeau
Guy Bostick	Camille Howe	Earle Roberts
Lois Burrell	Dorothy Johnson	Dave Ryan
Millie Carrier	Toni Krieger	Dorothy Ryan
George & Sylvia Chambers	Dena Lancashire	Helene Schulz
Helen Champlain	Steve Luxford	Dean Shull
Norma Conner	Elaine Maltese	Barbara A. Smith
Don Dinger	Rita Marcacci	Alee Swango
Jerry Dugger	Gene Marotti	Barbara Sweeney
Jana Easterling	Bob McClew	Carol Switalski
Jeanne Estes	Gladys Meier	Carolyn Thompson
Bill & Becky Everhart	Heidi Van Allen-Munoz	Ed Threadgill
Kathy Girouard	Joan Murphy	Meg Tucker
Marge Goodman	Nancy Neale	Penn Tucker
Pam Gray	Joe Oriani	Shirley Turner
Pete & Jean Harman	Dee Palmore	Betty von Hahmann
Frances Heath	Al & Marjorie Porter	Anne Windham

In the hospital: Roy Williamson

Family and friends

Stephanie Blanchard	Gale & Swen Waters' friend
Margaret Boylston	Barbara & John Puckett's friend
Jane Cain	Pam Gray's friend
Margaret Carswell	Barbara & John Puckett's friend
Katheryn Christie & family	Pen Tucker's friends
Stacy Crawley	Sue McClew's daughter
Kay Cunningham	Gale Waters' aunt
Marilyn Dorsey	Carol Carter's sister
Al Ellis	Jim Threlkel's friend
Cecily Faenza	Helen Champlain's niece
Raymond Fenstermaker	Gale & Gwen Waters' grandson
Wayne Harrison	Penn Tucker's friend
Jean Hehn	Ellie Threlkel's friend
Gladys Howard	Bob Howard's aunt
Abigail Ising	Rick & Pat Reass' great-niece
Erika Johnson	Lynn Oakley's friend
Pete Kent	Charley & Nancy Chilton's nephew
Geoff Lewis	David & Erin Emry's friend
Josh Lewis & family	Lynn Oakley's friend
Lynda & Rick Lewis	Jonathan Owen's friends
Nan Mason	Harvey & Mary Ann Snivley's daughter
Blain & Cynthia Thompson-McCaleb	Carolyn Thompson's daughter
Lynnis Mincey	Judy Winfree's friend
Leslie O'Neal	Les & Alison O'Neal's niece
LaDonna Owen	Jonathan Owen's aunt
Sue Peters	Kit Threlkel's friend
Cal Quessenberry	Ann Quessenberry's husband
Peggy Seigler	Ellie Threlkel's friend
David Smith	Penn Tucker's friend



Military service

Aaron Ashley	Sean Harp
James E. Baker	Coree Jones
Ben Clark	Terry Jones, Jr.
Deborah Clark	Jackie Jung
Nathan Connor	David Knowles
Tim Davis	Timothy Lee
Zach Drum	John Marotti
Leah (Doty) Fuscia	Kaitlin Marotti
Eddie Gray	Adam McPhail
Beau Gresham	Andrew Stapor
Chris Hagen	Keaton Thompson
Daniel Harp	Jacob van Zandt

Please help us visit our hospitalized members!

The tightening of HIPAA regulations has meant that we have missed visiting some of our members during their hospital stay. If you are a member or a friend of this congregation, or you have a family member admitted to any hospital, please call the church office and let the pastors know.

Thank you for helping us stay in touch with the congregation.

3 CENTS-A-MEAL NEXT SUNDAY, MARCH 15



The children will collect the **3 Cents-a-Meal Hunger Offering** during worship services **next Sunday**. This offering is divided between our Soup Kitchen/Bag Lunch Ministry, Beth-El Farm-workers Ministry, and Honduras.

* * * * *

WOMEN'S BIBLE STUDY



What good is your Faith? James forces us to face the implications of faith. Be inspired to put your faith into action in practical ways as you get to know both the man and the Book of James. Join Beth Moore as she explores such concepts as joy, hardship, faith, wisdom, single-mindedness, the tongue, humility, prayer, and more.

This interactive study features seven sessions of personal, daily assignments and eight group sessions with video. There are multiple levels of participation available. The dates for this study are **March 19, April 2, 16, and 30 at 9 - 11 a.m.** in the Edinburgh Annex. For more information and to request a workbook, please email Lia Gray at unpair@gmail.com or call her at 318-1541

* * * * *

EASTER IS COMING!!!

We are collecting plastic Easter Eggs for our Easter Egg hunt which will be held on Sunday, April 5 at 10:25 a.m. Please bring in your **plastic eggs already filled with candy or small prizes (no chocolate please)**. You may drop off the eggs in the main office or in the basket in McLeod Hall. Please have them delivered by **Monday, March 30**. Little ones through fifth grade are invited to attend the hunt.



* * * * *

PALM SUNDAY IS NEAR



All children of the church are invited to wave palms on **Sunday, March 29** at both services.

Please meet Mrs. Amy in the back of the sanctuary for the processional right before the services begin.

* * * * *

MAUNDY THURSDAY, APRIL 2, 2015 DINNER

Family Style Menu: Baked Ham, Macaroni and Cheese, Green Beans, Baked Beans, Cornbread Muffins, Assorted Cookies, and Coffee, Tea, or Lemonade

Cost: \$8.00 for adults and \$4.00 for children ages 5 – 10. Pre-K children and under eat for free.

Reservations required by Monday, **March 30, 2015**. Call the church office at 294-3121 or complete reservation form in bulletins and Tower Chimes.



MAUNDY THURSDAY RESERVATIONS

Name: _____ # of Adults: _____ # of Children: _____

* * * * *

2015 EASTER LILY ORDER FORM

It is time to order your Easter lily for Easter Sunday, April 5.

Easter lilies are a yearly tradition to decorate the church on Easter Sunday. To purchase a lily “in honor of” or “in memory of” a loved one or friend, please fill out the order form below.



The cost is \$12.00 per plant. Checks should be made payable to First Presbyterian Church and marked “Easter Lily Fund”. Place the order form and check in the offering plate, mail, or take to the church office by **Monday, March 30**. A complete listing will be available Easter Sunday.

The Sanctuary Committee will again remove the yellow stamen from each lily so it will not bother your allergies.

EASTER LILY ORDER FORM

Donor(s): _____ Number of plants ordered: _____ Amount Enclosed: \$ _____

In Memory of: _____ In Honor of: _____

I will pick up my lily after the 11:00 a.m. service Easter Sunday.

I would like my lily delivered to a shut-in.

DO YOU KNOW WHAT NEEDS TO HAPPEN BEFORE THE COMMUNION TRAYS ARE PASSED TO YOU?



The table must be covered with the under tablecloth. The bread must be cubed and put into plastic bags. The bread trays must be collected. The cups must be put in the holders of the trays and filled with grape juice. The bread, bread trays, and filled cup trays must be transported to the sanctuary as well as those prepared for the station from which the sacrament will be served in the balcony. The table must be set with these trays, the loaf of bread, the chalice, and the pitcher. Once these are in place the table is veiled.

After communion has been served for The Gathering Service at 8:50 a.m., there is tidying up and re-setting the table for the 11:00 a.m. service. Once communion has been served, the table must be cleared of all the trays, chalice, pitcher, and cloths. These are taken downstairs to be washed or cleaned and then returned to their storage places in the kitchen and elsewhere.

A lot happens before and after the communion trays are passed to you! We have a skeleton crew of faithful volunteers who serve you in this way, but **we need more!** Please consider this invitation to serve and if you feel that you are being called to assist in this important act of ministry, then please call Alan at the church office at 294-3121.

Thank you!

* * * * *

YOU CAN PLAY AN IMPORTANT ROLE IN OUR STEPHEN MINISTRY . . .

. . . Because you may know of a friend, neighbor, co-worker, or relative who is going through a difficult time and who could benefit from the focused care, encouragement, and support of a Stephen Minister.

If you know of someone who is hurting, talk with or call **Pat Reass at 206-9914**. Or talk with one of our other Stephen Minister Leaders: **Alan Harvey, Ray Larson, Mary Marrs, Steve Negley, Barbara Perkins, or Jean Strang**. You can also use one of the three Request Form Boxes (pictured right) located in the Centennial Room, narthex, and balcony hallway.



They can talk with you about how we can connect the person you know with one of our Stephen Ministers. It's a great way for you to show how much you care!

* * * * *

LADIES, JOIN ONE OF OUR BIBLE STUDY CIRCLES!!!



The two groups for our Presbyterian Women are the Lydia Circle and the Joy Circle. The Bible Study for this year is based on the Acts of the Apostles. Circle study leaders Jana and Carol will be using the Interpretation Bible Series as a resource for this look at the church in the power of the Holy Spirit. Bring your Bible and plan to join with other women of faith.

Jana Easterling leads the Lydia Circle on the **2nd Monday of the month at 10:00 a.m.** in the back of McLeod Hall. **AND...**

The Joy Circle meets the **3rd Tuesday of the month at 9:30 a.m.** at Carol Carter's house. Call Carol at 299-4253 if you need directions.

* * * * *

BRIGHT SUNDAY BUTTERFLY RELEASE

The Worship and Music Committee has approved purchasing butterflies to be released in memory of church members who have died since Bright Sunday, April 27, 2014, and for those who have sustained the loss of a **child, parent, sibling, or spouse since that date.**

As we have done for a number of years, if you would like to release a butterfly in memory of a loved one who died prior to, April 27, 2014, or who is beyond the relationship guidelines mentioned above (for example, grandparent, aunt, cousin, son-in-law, etc.), you may purchase a butterfly for \$5.00.

So that we may have an accurate count of how many butterflies to order, please fill out the tear off form at the bottom of this page and drop in the offering plate or drop off at the church office.

Or, you can call the office at 294-3121 with your information.

Since the order for butterflies needs to be placed soon, *please have your orders in by Palm Sunday, March 29.*

Your name: _____

Deceased loved one: _____ Relationship to you: _____

Which worship service April 12: 8:50 a.m. 11:00 a.m.



Generosity Shows in Our Church Facilities

The family of faith at First Presbyterian Church is truly blessed with a great complex of buildings in which to worship, learn of God's love, partake of fellowship with sisters and brothers in Christ, and use as a mission outpost for service to God in the world. Our church is blessed by wonderful physical resources for ministry.

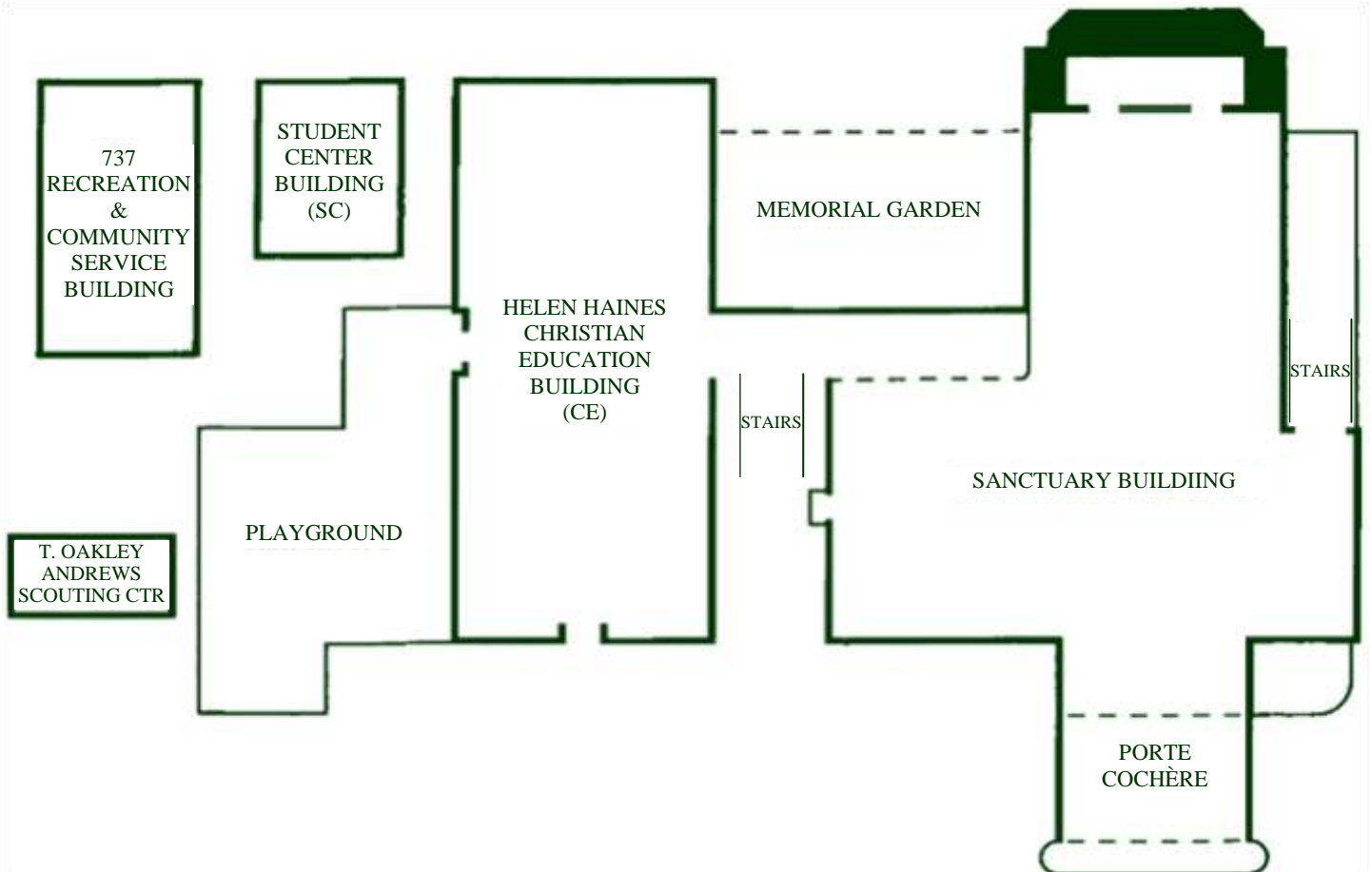

Our sanctuary building provides two magnificent spaces for the worship of God: our sanctuary (with a seating capacity of 700) and our chapel (for weddings, funerals, Christ Kids' worship and other events for groups of 80 or smaller). The sanctuary building also houses our kitchen, McLeod Hall, the church offices, the Price and Spencer Libraries, the Music Suite, and various meeting rooms.

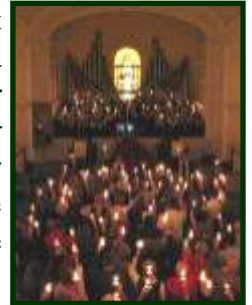

The Helen Haines Christian Education Building is the nerve center for our educational programs. The Nursery Suite, our Rotation Workshop Centers, the Children's Library, Children's Worship Center, Enrichment Room, Teacher Resource Center, and various adult classrooms fill the building.





The Student Center (at 711 Sixth Street, NW) which is currently undergoing repairs and renovations --- is home for our Middle School Youth, Senior High Youth, on Sundays and throughout the week.



The Recreation and Community Service Building at 737 Sixth Street, NW allows us to have covered recreation for our children and youth, a shop and storage for our maintenance director, and community outreach programs such as the Saturday Soup Kitchen and Saturday Nite Live.



The T Oakley Andrews Scouting Center is the base for Boy Scout Troop 121.



Our buildings also provide a basis for outreach in our community. Many people have their initial encounter with First Pres. through the doors of our Christian education buildings, not for Sunday School, but for meetings of community sponsored groups such as Al-Anon, the Alpha Jewels, the Quilters, the Stamp Club, the Magic Club.

Through the generosity of the members and friends of First Presbyterian Church, over the past year we have invested over \$200,000 in maintaining God's house, so that our congregation could offer all these different avenues for Christian ministry. These generous tithes and offerings have covered the costs for utilities, maintenance supplies, and insurance, and provided the services of Sam Bryant, our full-time Director of Facilities and Maintenance and Ann Quessenbery, our full-time Custodian. Your generosity shows each time God is praised in our wonderful facilities!

SUNDAY WORSHIP SCHEDULE

At **8:50 a.m.**, members and friends of First Presbyterian Church are invited to attend The Gathering. This service is held in the sanctuary. The piano is the primary instrument for leading in congregational music with a variety of instruments adding special touches from week to week. The prayers in worship and the flow of the service help the congregation gather in God's love. The Gathering ordinarily lasts 50 minutes and will conclude with the Benediction at 9:40 a.m.



At **11:00 a.m.**, you are invited to attend our later morning worship. This service is held in the sanctuary with music and responses regularly led by our chancel choir and accompanied by organ and piano. In the tradition of our church, cultivated over the last few decades, a full liturgy gives the congregation opportunities for spiritual enrichment and the sense of God's love and grace. This worship service ordinarily lasts one hour and concludes with the Benediction at 12:00 p.m.

We hope you will join us in worship, study, and fellowship!

CONNECT WITH US AT SUNDAY SCHOOL!!!

Children ages three and four gather in Room 108 for their own Sunday School time of crafts, snack, Bible lesson, and fun.

Children in kindergarten through fifth grade will rotate through Art, Science, Cooking, Storytelling, Computer, and Movies on Sunday mornings. The current theme is "Easter People".

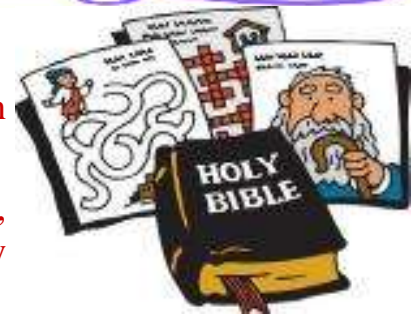

The Youth of the church, those in Middle School and High School, are invited to come hang out in the Girl Scout House from 9:45 - 10:45 a.m. We have a variety of volunteers who will lead this engaging class filled with faith-building, friendship, fun, food, and great times.

Connect - Grow - Thrive meets in Room 207. The class has been studying the book, *The Life You've Always Wanted: Spiritual Disciplines for Ordinary People* by John Ortberg. All are invited to join in this discussion filled class. Members of the class take part in leading the discussion each week.

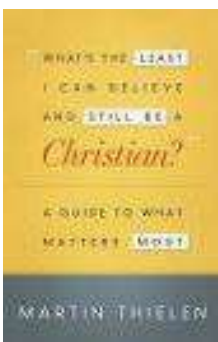
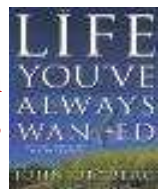

The Perspectives Class meets in the Geneva Room and is facilitated by Dr. Jim Threlkel and Glenn Thomas. They are focusing on Martin Thielen's book, *What's the Least I Can Believe and Still Be A Christian?* Everyone is invited to join in this thought-provoking discussion time. Pastor and author, Martin Thielen, has compiled a list of ten things people need to believe and ten things they don't, in order to be a Christian. This lively and engaging book will be a help to seekers as well as a comfort to believers who may find themselves questioning some of the assumptions they grew up with.

Dr. Steve Negley's class meets in the back of McLeod Hall. The new topic is *Unlocking the Parables from a First Century Middle-Eastern Perspective*. Bring your bible and be prepared to explore how the stories Jesus told can speak to us today.



First Presbyterian Church
637 6th Street, NW
Winter Haven, FL 33881
863-294-3121
FAX 863-294-1105
www.firstpreswh.org
office@firstpreswh.org

Our Purpose Statement

As a congregation of the Presbyterian Church (USA), First Presbyterian Church of Winter Haven exists to show God's kingdom to the world as we...

Share the good news of what God has done in Jesus Christ

Develop and nurture God's children into disciples

Provide a place and a program for praising God

Live our lives according to the Word, guided by the Spirit

Commit to justice for all God's people.

Adopted by Session, 2003

This newsletter is published weekly.
Summer months and holidays published bi-weekly.
Church dated material, please deliver by 3/13/15.

Non-profit Org.
U.S. Postage Paid
Permit No. 1162
Lakeland, FL

Bag Lunch Ministry

We gave out 218 bag lunches the week of 1/2/15.

Soup Kitchen Ministry

We fed 81 people on 3/7/15.

Return Service Requested

CALLING ALL PRIMETIMERS

(friends and member of First Pres in the 55 and up age group.)

Our next Primetimers is **Monday, March 23 at 11:30 a.m.** in McLeod Hall.

Come and enjoy great fellowship and a wonderful lunch catered by Joyce Snively.

Then enjoy Sue McClew's presentation of her 2014 Presbyterian Women Global Exchange to the Caribbean.



We will wrap up by 1:00 p.m.

To save your space at the lunch table, call Carol Switalski at 845-5416 or the church office at 294-3121.